

# M8 Series – With Plug Connection

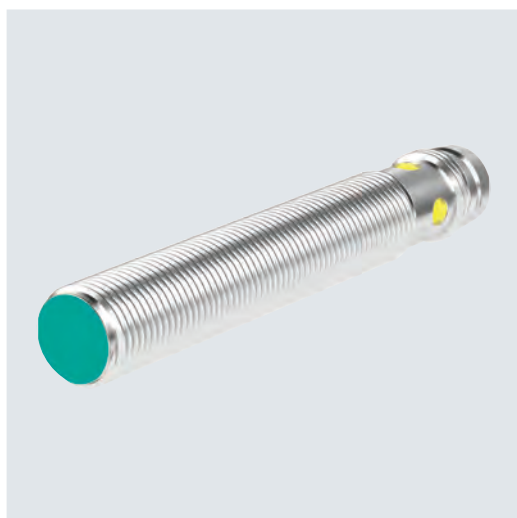

## Standard Technical Data

Voltage type	DC
Housing diameter D	8 mm

For detailed data and description, see the datasheet. Further products can be found online at [www.pepperl-fuchs.com](http://www.pepperl-fuchs.com).

Model number	Type of installation	Detection range [mm]	Output type	Output type	Switching function	Switching frequency [Hz]	UB (min)	UB (max)	Connection type	Cable length [mm]	Length L	CCC	CSA	UL
NCB1,5-8GM50-Z0-V3	Flush	1.5	2-wire	2-wire	Normally-open (NO)	1200	5	60	M8 connector plug		50	■	■	■
NCB1,5-8GM50-Z1-V3	Flush	1.5	2-wire	2-wire	Normally-closed (NC)	1200	5	60	M8 connector plug		50	■	■	■
NBB1,5-8GM50-Z3-V3	Flush	1.5	2-wire	2-wire	Normally-open (NO)	1200	5	60	M8 connector plug		48	■	■	■
NBB2-8GH20-E0-V3	Flush	2	3-wire	NPN	Normally-open (NO)	1500	10	30	M8 connector plug		30	■	■	■
NBB2-8GH20-E2-V3	Flush	2	3-wire	PNP	Normally-open (NO)	1500	10	30	M8 connector plug		30	■	■	■
NBB2-8GH25-E0-V3	Flush	2	3-wire	NPN	Normally-open (NO)	1500	10	30	M8 connector plug		35	■	■	■
NBB2-8GH25-E2-V3	Flush	2	3-wire	PNP	Normally-open (NO)	1500	10	30	M8 connector plug		35	■	■	■
NBB2-8GH40-E0-V3	Flush	2	3-wire	NPN	Normally-open (NO)	1500	10	30	M8 connector plug		50	■	■	■
NBB2-8GH40-E2-V3	Flush	2	3-wire	PNP	Normally-open (NO)	1500	10	30	M8 connector plug		50	■	■	■
NBB2-8GM25-E0-V3	Flush	2	3-wire	NPN	Normally-open (NO)	6000	5	30	M8 connector plug		40	■	■	■
NBB2-8GM25-E1-V3	Flush	2	3-wire	NPN	Normally-closed (NC)	6000	5	30	M8 connector plug		40	■	■	■
NBB2-8GM25-E2-V3	Flush	2	3-wire	PNP	Normally-open (NO)	6000	5	30	M8 connector plug		40	■	■	■
NBB2-8GM25-E3-V3	Flush	2	3-wire	PNP	Normally-closed (NC)	6000	5	30	M8 connector plug		40	■	■	■
NBB2-8GM30-A0-V1	Flush	2	4-wire	NPN	Complementary	6000	5	30	M12 connector plug		55	■	■	■
NBB2-8GM30-A2-V1	Flush	2	4-wire	PNP	Complementary	6000	5	30	M12 connector plug		55	■	■	■
NBB2-8GM30-E0-V1	Flush	2	3-wire	NPN	Normally-open (NO)	6000	5	30	M12 connector plug		55	■	■	■
NBB2-8GM30-E2-0,2M-V3	Flush	2	3-wire	PNP	Normally-open (NO)	6000	5	30	Fixed cable with M8 plug	200	30	■	■	■
NBB2-8GM30-E2-0,3M-V3	Flush	2	3-wire	PNP	Normally-open (NO)	6000	5	30	Fixed cable with M8 plug	300	30	■	■	■
NBB2-8GM30-E2-0,5M-PUR-V1	Flush	2	3-wire	PNP	Normally-open (NO)	6000	5	30	Fixed cable with M12 plug	500	30	■	■	■
NBB2-8GM30-E2-0,5M-V1	Flush	2	3-wire	PNP	Normally-open (NO)	6000	5	30	Fixed cable with M12 plug	500	30	■	■	■
NBB2-8GM30-E2-V1	Flush	2	3-wire	PNP	Normally-open (NO)	6000	5	30	M12 connector plug		55	■	■	■
NBB2-8GM40-A0-V1	Flush	2	4-wire	NPN	Complementary	6000	5	30	M12 connector plug		65	■	■	■
NBB2-8GM40-A2-V1	Flush	2	4-wire	PNP	Complementary	6000	5	30	M12 connector plug		65	■	■	■
NBB2-8GM40-E0-V1	Flush	2	3-wire	NPN	Normally-open (NO)	6000	5	30	M12 connector plug		65	■	■	■
NBB2-8GM40-E0-V3	Flush	2	3-wire	NPN	Normally-open (NO)	6000	5	30	M8 connector plug		55	■	■	■
NBB2-8GM40-E2-0,2M-V1	Flush	2	3-wire	PNP	Normally-open (NO)	6000	5	30	Fixed cable with M12 plug	200	40	■	■	■
NBB2-8GM40-E2-0,3M-V3	Flush	2	3-wire	PNP	Normally-open (NO)	6000	5	30	Fixed cable with M8 plug	300	40	■	■	■
NBB2-8GM40-E2-V1	Flush	2	3-wire	PNP	Normally-open (NO)	6000	5	30	M12 connector plug		65	■	■	■
NBB2-8GM40-E2-V3	Flush	2	3-wire	PNP	Normally-open (NO)	6000	5	30	M8 connector plug		55	■	■	■
NBB2-8GM40-E3-V1	Flush	2	3-wire	PNP	Normally-closed (NC)	6000	5	30	M12 connector plug		65	■	■	■
NBB2-8GM40-E3-V3	Flush	2	3-wire	PNP	Normally-closed (NC)	6000	5	30	M8 connector plug		55	■	■	■
NBB2-8GS35-E0-V1	Flush	2	3-wire	NPN	Normally-open (NO)	6000	5	30	M12 connector plug		60	■	■	■
NBB2-8GS35-E1-V3	Flush	2	3-wire	NPN	Normally-closed (NC)	6000	5	30	M8 connector plug		50	■	■	■
NBB2-8GS35-E2-V1	Flush	2	3-wire	PNP	Normally-open (NO)	6000	5	30	M12 connector plug		60	■	■	■
NBB2-8GS35-E2-V3	Flush	2	3-wire	PNP	Normally-open (NO)	6000	5	30	M8 connector plug		50	■	■	■
NBB2-8GS35-E3-V1	Flush	2	3-wire	PNP	Normally-closed (NC)	6000	5	30	M12 connector plug		60	■	■	■
NBB2-8GS35-E3-V3	Flush	2	3-wire	PNP	Normally-closed (NC)	6000	5	30	M8 connector plug		50	■	■	■
NBB2-8GS40-E2-V1	Flush	2	3-wire	PNP	Normally-open (NO)	6000	5	30	M12 connector plug		65	■	■	■

Model number	Type of installation	Detection range [mm]	Output type	Output type	Switching function	Switching frequency [Hz]	UB (min)	UB (max)	Connection type	Cable length [mm]	Length L	CCC	CSA	UL
NBB2-8GS40-E2-V3	Flush	2	3-wire	PNP	Normally-open (NO)	6000	5	30	M8 connector plug		55			■
NBB2-8GS40-E3-V1	Flush	2	3-wire	PNP	Normally-closed (NC)	6000	5	30	M12 connector plug		65			■
NCN2-8GM50-Z0-V3	Non-flush	2	2-wire	2-wire	Normally-open (NO)	1200	5	60	M8 connector plug		40	■	■	■
NCN2-8GM50-Z1-V3	Non-flush	2	2-wire	2-wire	Normally-closed (NC)	1200	5	60	M8 connector plug		40	■	■	■
NXB2-8GM25-E2-V3	Flush	2	3-wire	PNP	Normally-open (NO)	1000	10	30	M8 connector plug		40			
NEB3-8GM40-E0-V1	Flush	3	3-wire	NPN	Normally-open (NO)	3500	5	30	M12 connector plug		65			■
NEB3-8GM40-E0-V3	Flush	3	3-wire	NPN	Normally-open (NO)	3500	5	30	M8 connector plug		55			■
NEB3-8GM40-E1-V1	Flush	3	3-wire	NPN	Normally-closed (NC)	3500	5	30	M12 connector plug		65			■
NEB3-8GM40-E1-V3	Flush	3	3-wire	NPN	Normally-closed (NC)	3500	5	30	M8 connector plug		55			■
NEB3-8GM40-E2-V1	Flush	3	3-wire	PNP	Normally-open (NO)	3500	5	30	M12 connector plug		65			■
NEB3-8GM40-E2-V3	Flush	3	3-wire	PNP	Normally-open (NO)	3500	5	30	M8 connector plug		55			■
NEB3-8GM40-E3-V1	Flush	3	3-wire	PNP	Normally-closed (NC)	3500	5	30	M12 connector plug		65			■
NEB3-8GM40-E3-V3	Flush	3	3-wire	PNP	Normally-closed (NC)	3500	5	30	M8 connector plug		55			■
NEB4-8GM50-E2-V3	Semi-flush	4	3-wire	PNP	Normally-open (NO)	500	10	30	M8 connector plug		45.5		■	■
NBN2-8GM50-Z1-V3	Non-flush	2	2-wire	2-wire	Normally-closed (NC)	1200	5	60	M8 connector plug		48	■	■	■
NBN2-8GM50-Z3-V3	Non-flush	2	2-wire	2-wire	Normally-open (NO)	1200	5	60	M8 connector plug		48	■	■	■
NBN3-8GM25-E0-V3	Non-flush	3	3-wire	NPN	Normally-open (NO)	4500	5	30	M8 connector plug		40			■
NBN3-8GM25-E1-V3	Non-flush	3	3-wire	NPN	Normally-closed (NC)	4500	5	30	M8 connector plug		40			■
NBN3-8GM25-E2-V3	Non-flush	3	3-wire	PNP	Normally-open (NO)	4500	5	30	M8 connector plug		40			■
NBN3-8GM25-E3-V3	Non-flush	3	3-wire	PNP	Normally-closed (NC)	4500	5	30	M8 connector plug		40			■
NBN3-8GM30-E0-V1	Non-flush	3	3-wire	NPN	Normally-open (NO)	4500	5	30	M12 connector plug		55			■
NBN3-8GM30-E2-V1	Non-flush	3	3-wire	PNP	Normally-open (NO)	4500	5	30	M12 connector plug		55			■
NBN3-8GM40-A0-V1	Non-flush	3	4-wire	NPN	Complementary	4500	5	30	M12 connector plug		65			■
NBN3-8GM40-A2-V1	Non-flush	3	4-wire	PNP	Complementary	4500	5	30	M12 connector plug		65			■
NBN3-8GM40-E0-V1	Non-flush	3	3-wire	NPN	Normally-open (NO)	4500	5	30	M12 connector plug		65			■
NBN3-8GM40-E2-V1	Non-flush	3	3-wire	PNP	Normally-open (NO)	4500	5	30	M12 connector plug		65			■
NBN3-8GM40-E2-V3	Non-flush	3	3-wire	PNP	Normally-open (NO)	4500	5	30	M8 connector plug		55			■
NBN3-8GS35-E0-V3	Non-flush	3	3-wire	NPN	Normally-open (NO)	4500	5	30	M8 connector plug		50			■
NBN3-8GS35-E1-V3	Non-flush	3	3-wire	NPN	Normally-closed (NC)	4500	5	30	M8 connector plug		50			■
NBN3-8GS35-E2-V1	Non-flush	3	3-wire	PNP	Normally-open (NO)	4500	5	30	M12 connector plug		60			■
NBN3-8GS35-E2-V3	Non-flush	3	3-wire	PNP	Normally-open (NO)	4500	5	30	M8 connector plug		50			■
NBN3-8GS35-E3-V3	Non-flush	3	3-wire	PNP	Normally-closed (NC)	4500	5	30	M8 connector plug		50			■
NXN3-8GM25-E2-V3	Non-flush	3	3-wire	PNP	Normally-open (NO)	1000	10	30	M8 connector plug		40			
NEN6-8GM40-E0-V1	Non-flush	6	3-wire	NPN	Normally-open (NO)	1500	5	30	M12 connector plug		65			■
NEN6-8GM40-E0-V3	Non-flush	6	3-wire	NPN	Normally-open (NO)	1500	5	30	M8 connector plug		55			■
NEN6-8GM40-E1-V1	Non-flush	6	3-wire	NPN	Normally-closed (NC)	1500	5	30	M12 connector plug		65			■
NEN6-8GM40-E1-V3	Non-flush	6	3-wire	NPN	Normally-closed (NC)	1500	5	30	M8 connector plug		55			■
NEN6-8GM40-E2-V1	Non-flush	6	3-wire	PNP	Normally-open (NO)	1500	5	30	M12 connector plug		65			■
NEN6-8GM40-E2-V3	Non-flush	6	3-wire	PNP	Normally-open (NO)	1500	5	30	M8 connector plug		55			■
NEN6-8GM40-E3-V1	Non-flush	6	3-wire	PNP	Normally-closed (NC)	1500	5	30	M12 connector plug		65			■
NEN6-8GM40-E3-V3	Non-flush	6	3-wire	PNP	Normally-closed (NC)	1500	5	30	M8 connector plug		55			■

Accessories	
<b>BF 8</b>	Mounting adapter, 8 mm
<b>EXG-08</b>	Quick-mounting bracket with fixed stop
<b>V1-G-2M-PUR</b>	Single-ended female cordset, M12, 4-pin, PUR cable
<b>V1-W-2M-PUR</b>	Single-ended female cordset, M12, 4-pin, PUR cable
<b>V3-WM-2M-PUR</b>	Single-ended female cordset, M8, 3-pin, PUR cable
<b>V3-WMV4A-5M-PUR</b>	Single-ended female cordset, M8, stainless steel V4A, 3-pin, PUR cable

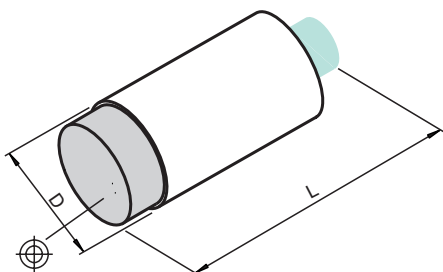

# M8 Series – With Cable Connection



## Standard Technical Data

<b>Voltage type</b>	DC
<b>Connection type</b>	Fixed cable
<b>Housing diameter D</b>	8 mm

For detailed data and description, see the datasheet. Further products can be found online at [www.pepperl-fuchs.com](http://www.pepperl-fuchs.com).

Model number	Type of installation	Detection range [mm]	Output type	Output type	Switching function	Switching frequency [Hz]	UB (min)	UB (max)	Cable length [mm]	Cable material	Length L	CCC	CSA	UL
NBB1,5-8GM40-Z0	Flush	1.5	2-wire	2-wire	Normally-open (NO)	1200	5	60	2000	PVC	40	■	■	■
NBB1,5-8GM40-Z1	Flush	1.5	2-wire	2-wire	Normally-closed (NC)	1200	5	60	2000	PVC	40	■	■	■
NCB1,5-8GM40-Z0	Flush	1.5	2-wire	2-wire	Normally-open (NO)	1200	5	60	2000	PUR	40	■	■	■
NCB1,5-8GM40-Z1	Flush	1.5	2-wire	2-wire	Normally-closed (NC)	1200	5	60	2000	PUR	40	■	■	■
NBB2-8GM30-E0	Flush	2	3-wire	NPN	Normally-open (NO)	6000	5	30	2000	PVC	30			■
NBB2-8GM30-E0-5M-PUR	Flush	2	3-wire	NPN	Normally-open (NO)	6000	5	30	5000	PUR	30			■
NBB2-8GM30-E2	Flush	2	3-wire	PNP	Normally-open (NO)	6000	5	30	2000	PVC	30			■
NBB2-8GM30-E2-10M	Flush	2	3-wire	PNP	Normally-open (NO)	6000	5	30	10000	PVC	30			■
NBB2-8GM30-E2-5M	Flush	2	3-wire	PNP	Normally-open (NO)	6000	5	30	5000	PVC	30			■
NBB2-8GM30-E2-5M-PUR	Flush	2	3-wire	PNP	Normally-open (NO)	6000	5	30	5000	PUR	30			■
NBB2-8GM30-E3	Flush	2	3-wire	PNP	Normally-closed (NC)	6000	5	30	2000	PVC	30			■
NBB2-8GM30-E3-10M	Flush	2	3-wire	PNP	Normally-closed (NC)	6000	5	30	10000	PVC	30			■
NBB2-8GM30-E3-5M	Flush	2	3-wire	PNP	Normally-closed (NC)	6000	5	30	5000	PVC	30			■
NBB2-8GM35-E2-3M-PUR	Flush	2	3-wire	PNP	Normally-open (NO)	6000	5	30	3000	PUR	35			■
NBB2-8GM40-E2	Flush	2	3-wire	PNP	Normally-open (NO)	6000	5	30	2000	PVC	40			■
NBB2-8GM40-E3	Flush	2	3-wire	PNP	Normally-closed (NC)	6000	5	30	2000	PVC	40			■
NBB2-8GM50-A0	Flush	2	3-wire	NPN	Complementary	6000	5	30	2000	PVC	50			■
NBB2-8GM50-A2	Flush	2	3-wire	PNP	Complementary	6000	5	30	2000	PVC	50			■
NBB2-8GM50-A2-5M	Flush	2	3-wire	PNP	Complementary	6000	5	30	5000	PVC	50			■
NBB2-8GM50-E0	Flush	2	3-wire	NPN	Normally-open (NO)	6000	5	30	2000	PVC	50			■
NBB2-8GM50-E0-5M	Flush	2	3-wire	NPN	Normally-open (NO)	6000	5	30	5000	PVC	50			■
NBB2-8GM50-E2	Flush	2	3-wire	PNP	Normally-open (NO)	6000	5	30	2000	PVC	50			■
NBB2-8GM50-E2-3M	Flush	2	3-wire	PNP	Normally-open (NO)	6000	5	30	3000	PVC	50			■
NBB2-8GM50-E2-5M	Flush	2	3-wire	PNP	Normally-open (NO)	6000	5	30	5000	PVC	50			■
NBB2-8GM50-E2-PUR	Flush	2	3-wire	PNP	Normally-open (NO)	6000	5	30	2000	PUR	50			■
NBB2-8GS16-E0	Flush	2	3-wire	NPN	Normally-open (NO)	6000	5	30	2000	PVC	16			■
NBB2-8GS16-E2	Flush	2	3-wire	PNP	Normally-open (NO)	6000	5	30	2000	PVC	16			■
NBB2-8GS16-E2-3M-PUR	Flush	2	3-wire	PNP	Normally-open (NO)	6000	5	30	3000	PUR	16			■
NBB2-8GS16-E3	Flush	2	3-wire	PNP	Normally-closed (NC)	6000	5	30	2000	PVC	16			■
NBB2-8GS30-E3-3M-PUR	Flush	2	3-wire	PNP	Normally-closed (NC)	6000	5	30	3000	PUR	30			■
NBB2-8GS35-E0-PUR	Flush	2	3-wire	NPN	Normally-open (NO)	6000	5	30	2000	PUR	35			■
NBB2-8GS35-E1-PUR	Flush	2	3-wire	NPN	Normally-closed (NC)	6000	5	30	2000	PUR	35			■
NBB2-8GS35-E2-5M-PUR	Flush	2	3-wire	PNP	Normally-open (NO)	6000	5	30	5000	PUR	35			■
NBB2-8GS35-E2-PUR	Flush	2	3-wire	PNP	Normally-open (NO)	6000	5	30	2000	PUR	35			■
NBB2-8GS35-E3-8M-PUR	Flush	2	3-wire	PNP	Normally-closed (NC)	6000	5	30	8000	PUR	35			■
NBB2-8GS35-E3-PUR	Flush	2	3-wire	PNP	Normally-closed (NC)	6000	5	30	2000	PUR	35			■
NBB2-8GS40-E0-5M-PUR	Flush	2	3-wire	NPN	Normally-open (NO)	6000	5	30	5000	PUR	40			■
NBB2-8GS40-E0-PUR	Flush	2	3-wire	NPN	Normally-open (NO)	6000	5	30	2000	PUR	40			■

Model number	Type of installation	Detection range [mm]	Output type	Output type	Switching function	Switching frequency [Hz]	UB (min)	UB (max)	Cable length [mm]	Cable material	Length L	CCC	CSA	UL
NBB2-8GS40-E2-5M-PUR	Flush	2	3-wire	PNP	Normally-open (NO)	6000	5	30	5000	PUR	40			■
NBB2-8GS40-E2-PUR	Flush	2	3-wire	PNP	Normally-open (NO)	6000	5	30	2000	PUR	40			■
NBB2-8GS40-E3-10M-PUR	Flush	2	3-wire	PNP	Normally-closed (NC)	6000	5	30	10000	PUR	40			■
NBB2-8GS40-E3-PUR	Flush	2	3-wire	PNP	Normally-closed (NC)	6000	5	30	2000	PUR	40			■
NBB2-8GS50-E0-PUR	Flush	2	3-wire	NPN	Normally-open (NO)	6000	5	30	2000	PUR	50			■
NBB2-8GS50-E2	Flush	2	3-wire	PNP	Normally-open (NO)	6000	5	30	2000	PVC	50			■
NBB2-8GS50-E2-0,6M-PUR	Flush	2	3-wire	PNP	Normally-open (NO)	6000	5	30	600	PUR	50			■
NBB2-8GS50-E2-3,5M-PUR	Flush	2	3-wire	PNP	Normally-open (NO)	6000	5	30	5000	PUR	50			■
NBB2-8GS50-E2-5M-PUR	Flush	2	3-wire	PNP	Normally-open (NO)	6000	5	30	5000	PUR	50			■
NBB2-8GS50-E2-PUR	Flush	2	3-wire	PNP	Normally-open (NO)	6000	5	30	2000	PUR	50			■
NBB2-8GS50-E3-PUR	Flush	2	3-wire	PNP	Normally-closed (NC)	6000	5	30	2000	PUR	50			■
NXB2-8GM30-E2	Flush	2	3-wire	PNP	Normally-open (NO)	1000	10	30	2000	PVC	30			
NEB3-8GM40-E0-PUR	Flush	3	3-wire	NPN	Normally-open (NO)	3500	5	30	2000	PUR	40			■
NEB3-8GM40-E1-PUR	Flush	3	3-wire	NPN	Normally-closed (NC)	3500	5	30	2000	PUR	40			■
NEB3-8GM40-E2-PUR	Flush	3	3-wire	PNP	Normally-open (NO)	3500	5	30	2000	PUR	40			■
NEB3-8GM40-E3-PUR	Flush	3	3-wire	PNP	Normally-closed (NC)	3500	5	30	2000	PUR	40			■
NEB4-8GM45-E2	Semi-flush	4	3-wire	PNP	Normally-open (NO)	500	10	30	2000	PUR	45		■	■
NCN2-8GM40-Z0	Non-flush	2	2-wire	2-wire	Normally-open (NO)	1200	5	60	2000	PUR	40	■	■	■
NCN2-8GM40-Z1	Non-flush	2	2-wire	2-wire	Normally-closed (NC)	1200	5	60	2000	PUR	40	■	■	■
NBN2-8GM40-Z1	Non-flush	2	2-wire	2-wire	Normally-closed (NC)	1200	5	60	2000	PVC	40	■	■	■
NBN3-8GM30-E0	Non-flush	3	3-wire	NPN	Normally-open (NO)	4500	5	30	2000	PVC	30			■
NBN3-8GM30-E2	Non-flush	3	3-wire	PNP	Normally-open (NO)	4500	5	30	2000	PVC	30			■
NBN3-8GM30-E2-5M	Non-flush	3	3-wire	PNP	Normally-open (NO)	4500	5	30	5000	PVC	30			■
NBN3-8GM30-E3	Non-flush	3	3-wire	PNP	Normally-closed (NC)	4500	5	30	2000	PVC	30			■
NBN3-8GM50-A0	Non-flush	3	3-wire	NPN	Complementary	4500	5	30	2000	PVC	50			■
NBN3-8GM50-A2	Non-flush	3	3-wire	PNP	Complementary	4500	5	30	2000	PVC	50			■
NBN3-8GM50-E0	Non-flush	3	3-wire	NPN	Normally-open (NO)	4500	5	30	2000	PVC	50			■
NBN3-8GM50-E2	Non-flush	3	3-wire	PNP	Normally-open (NO)	4500	5	30	2000	PVC	50			■
NBN3-8GS35-E1-PUR	Non-flush	3	3-wire	NPN	Normally-closed (NC)	4500	5	30	2000	PUR	35			■
NBN3-8GS35-E2-5M-PUR	Non-flush	3	3-wire	PNP	Normally-open (NO)	4500	5	30	5000	PUR	35			■
NBN3-8GS40-E0-PUR	Non-flush	3	3-wire	NPN	Normally-open (NO)	4500	5	30	2000	PUR	40			■
NBN3-8GS40-E2-10M-PUR	Non-flush	3	3-wire	PNP	Normally-open (NO)	4500	5	30	10000	PUR	40			■
NBN3-8GS40-E2-PUR	Non-flush	3	3-wire	PNP	Normally-open (NO)	4500	5	30	2000	PUR	40			■
NBN3-8GS40-E3-PUR	Non-flush	3	3-wire	PNP	Normally-closed (NC)	4500	5	30	2000	PUR	40			■
NXN3-8GM30-E2	Non-flush	3	3-wire	PNP	Normally-open (NO)	1000	10	30	2000	PVC	30			
NEN6-8GM40-E0-PUR	Non-flush	6	3-wire	NPN	Normally-open (NO)	1500	5	30	2000	PUR	40			■
NEN6-8GM40-E1-PUR	Non-flush	6	3-wire	NPN	Normally-closed (NC)	1500	5	30	2000	PUR	40			■
NEN6-8GM40-E2-PUR	Non-flush	6	3-wire	PNP	Normally-open (NO)	1500	5	30	2000	PUR	40			■
NEN6-8GM40-E3-PUR	Non-flush	6	3-wire	PNP	Normally-closed (NC)	1500	5	30	2000	PUR	40			■

### Accessories

<b>BF 8</b>	Mounting adapter, 8 mm
<b>EXG-08</b>	Quick-mounting bracket with fixed stop

